

REV	LOCATIONS	DESCRIPTION	DATE	REVISER	APPD

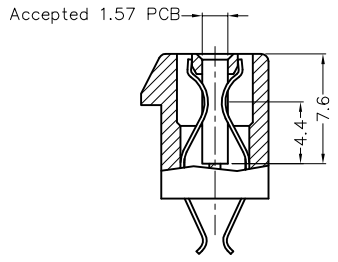
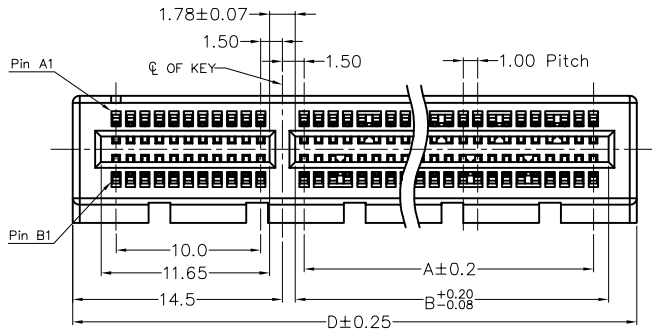

SECTION G-G

SPECIFICATIONS

Electrical
 Current Rating: 1.1A AC(rms)/DC
 Voltage Rating: 50V AC(rms)/DC
 Contact Resistance: 30mΩ Max
 Insulation Resistance: 1000MΩ Min
 Withstanding Voltage: 500V AC r.m.s
 Temperature Range-Operating: -40°C ~ +85°C

Material

Housing: PA9T (UL 94V-0) Black
 Contact: Phosphor bronze/ Selected gold plated on contact area, 100u" Min. matte Tin plated on solder tails

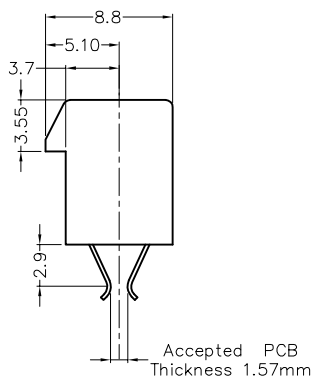
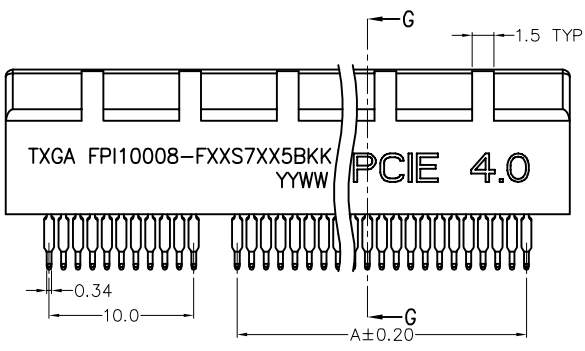

Ordering Information

FPI 100 08 - F XX S 7 XX 5 BK X
 1 2 3 4 5 6 7 8 9 10 11

1	Category FPI-PCIE	2	Series Number 100-Pitch1.00mm	3	Distinction No. 08	4	Type F-Female	5	Circuits XX	6	Entry Angle S-180° Vertical
7	Plating 7-Selective gold plated on contact area and matte tin plated on tails area	8	Thickness of Plating 00-Gold Flash 15-0.375µm 30-0.75µm	9	Material-Resin 5-PA9T	10	Color-Resin BK-Black	11	Packaging K-Tray with cap		

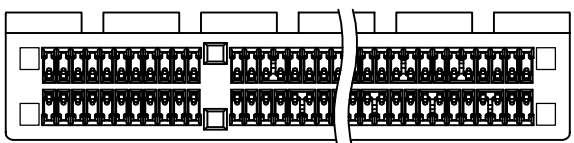

<p>THIRD ANGLE PROJECTION</p>	GENERAL TOLERANCES (UNLESS SPECIFIED)		APPROVE BY LEO	DATE 26/OCT/20	PART NO. FPI10008-FXXS7XX5BKK	ITEM NO. FPI10008	<p>Building Technology Cornerstone</p>	
	X. ±0.30	X.* ±5°	CHECKED BY GISELLE	DATE 26/OCT/20	TITLE PCI Express Gen4(16GT/S) Pitch 1.0mm 180° Vertical			REV 0
	DESIGN UNITS METRIC(mm)	X.X ±0.20	X.X* ±2°	DRAWN BY MATT	DATE 26/OCT/20	THIS DRAWING CONTAINS INFORMATION THAT IS PROPRIETARY TO TXGA INDUSTRIAL ELECTRONICS(S.Z)CO.,LTD AND SHOULD NOT BE USED WITHOUT WRITTEN PERMISSION		
SCALE 5:1	SIZE A4	X.XX ±0.15	X.XX* ±1°					
X.XXX ±0.10	X.XXX* ±0.5°							

REV	LOCATIONS	DESCRIPTION	DATE	REVISER	APPD

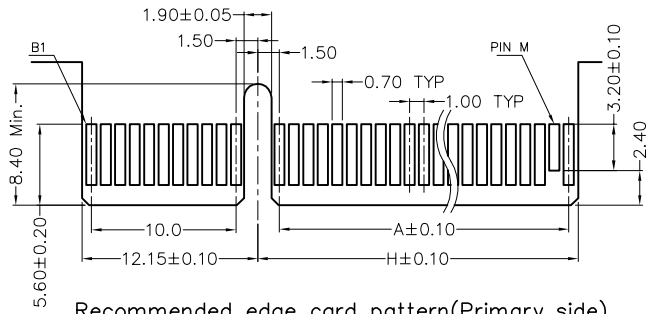

Recommended edge card pattern(Primary side)
General Tolerances: ±0.05mm

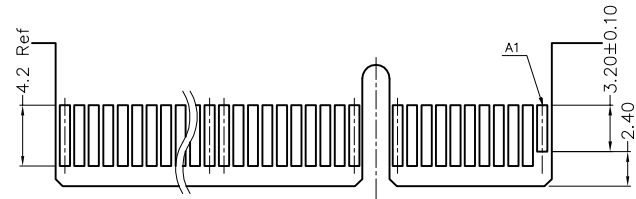
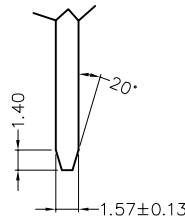

Recommended edge card pattern(Secondary side)
General Tolerances: ±0.05mm

Circuits(n)	Part No.	Dimensions (mm)					
		A	B	D	F	H	M
36	FPI10008-F36S7XX5BKK	6.0	7.65	25.0	20.4	8.15	B17
64	FPI10008-F64S7XX5BKK	20.0	21.65	39.0	34.4	22.15	B31
98	FPI10008-F98S7XX5BKK	37.0	38.65	56.0	51.4	39.15	B48
164	FPI10008-F164S7XX5BKK	70.0	71.65	89.0	84.4	72.15	B81

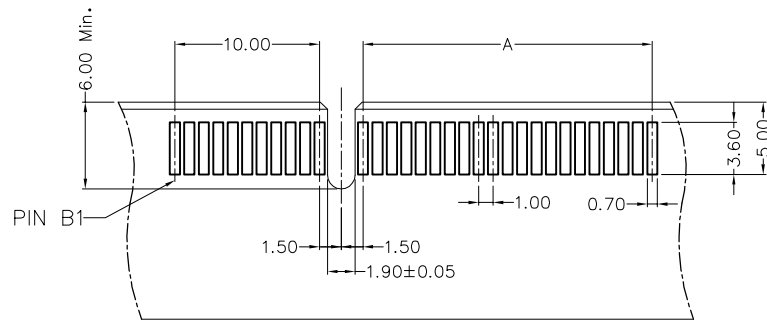

Recommended P.C.Board Layout
General Tolerances: ±0.05mm

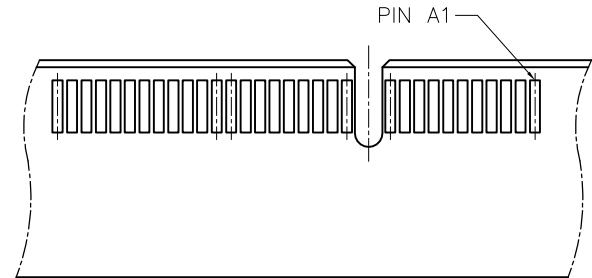
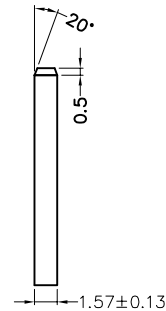

 THIRD ANGLE PROJECTION DESIGN UNITS METRIC(mm) SCALE 5:1 SIZE A4	GENERAL TOLERANCES (UNLESS SPECIFIED)		APPROVE BY LEO	DATE 26/OCT/20	PART NO. FPI10008-FXXS7XX5BKK	ITEM NO. FPI10008	 Building Technology Cornerstone
	X. ±0.30	X.* ±5°	CHECKED BY GISELLE	DATE 26/OCT/20	TITLE PCI Express Gen4(16GT/S) Pitch 1.0mm 180° Vertical		
	X.X ±0.20	X.X* ±2°	DRAWN BY MATT	DATE 26/OCT/20	THIS DRAWING CONTAINS INFORMATION THAT IS PROPRIETARY TO TXGA INDUSTRIAL ELECTRONICS(S.Z)CO.,LTD AND SHOULD NOT BE USED WITHOUT WRITTEN PERMISSION		SHEET NO. 2/3
	X.XX ±0.15	X.XX* ±1°					
X.XXX ±0.10	X.XXX* ±0.5°						

REV	LOCATIONS	DESCRIPTION	DATE	REVISER	APPD

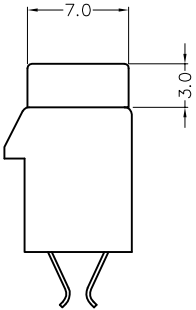
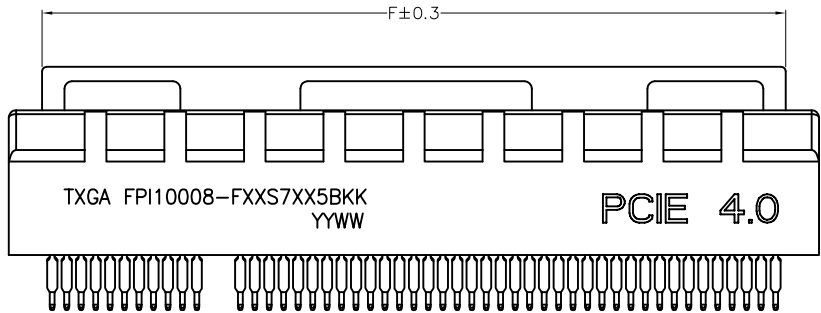
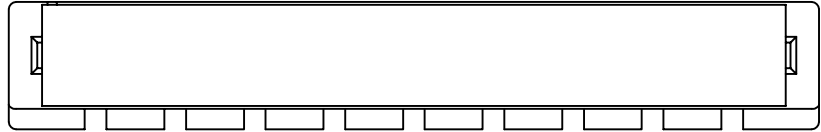

WITH CAP

<p>THIRD ANGLE PROJECTION</p>	GENERAL TOLERANCES (UNLESS SPECIFIED)		APPROVE BY	DATE	PART NO.	ITEM NO.	<p>Building Technology Cornerstone</p>
	X. ±0.30	X.° ±5'	LEO	26/OCT/20	FP110008-FXXS7XX5BKK	FP110008	
	X.X ±0.20	X.X' ±2"	CHECKED BY	DATE	TITLE	REV 0	SHEET NO. 3/3
	X.XX ±0.15	X.XX' ±1"	GISELLE	26/OCT/20	PCI Express Gen4(16GT/S) Pitch 1.0mm 180° Vertical	THIS DRAWING CONTAINS INFORMATION THAT IS PROPRIETARY TO TXGA INDUSTRIAL ELECTRONICS(S.Z)CO.,LTD AND SHOULD NOT BE USED WITHOUT WRITTEN PERMISSION	
SCALE	SIZE	X.XXX ±0.10	X.XXX' ±0.5"	DRAWN BY	DATE		
5:1	A4			MATT	26/OCT/20		